

Wall Mount Installation Guide For 65" & 75", 85" & 86" & 98"

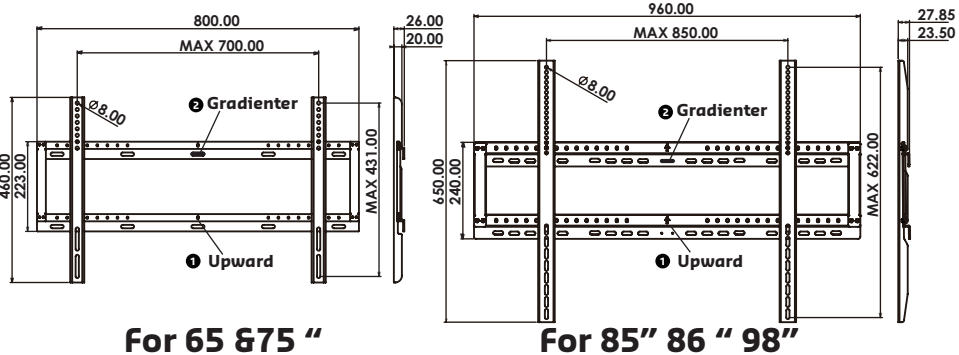

For 65 & 75 "

For 85" 86 " 98"

- As shown in the figure, an arrow is marked at position ①. The installation direction should be in accordance with the arrow upward.
- A gradienter meter is at position ②. You can adjust the horizontal direction according to the gradienter meter.

Package contents

Open the packages and check the contents. If any item is missing or damaged, please contact your dealer immediately.

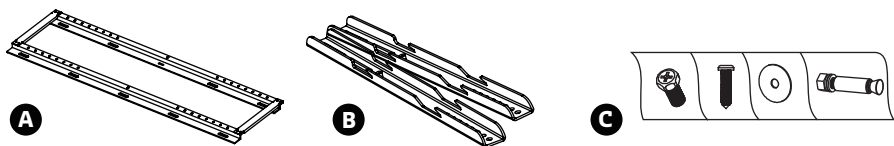

- | | |
|--------------------------------|---------|
| A. Monitor Wall Mount Bracket | x 1 pcs |
| B. Wall Mount Crossbar Bracket | x 2 pcs |
| C. Screws package | x 1 bag |
| D. Installation guide | x 1 pcs |

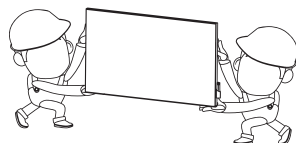

Safety precautions

- Please read this instruction before mounting and follow this step below precisely.
- It should be installed by at least two persons. Refer the installation to qualified technicians. Improper installation may cause the monitor to fall or malfunction.
- The installation site must be made of strong and solid material, such as solid brick or concrete, when in doubt, please consult contact technician, before installing.

Step. 1

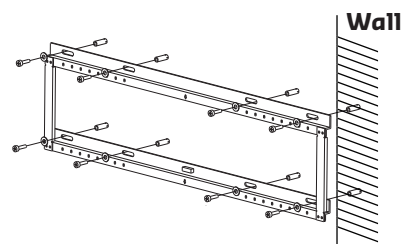

△ The diameter of the hole on the wall should be smaller than the diameter of the screws. (Note: the diameter of the hole on the wall should be smaller than 10mm.)

- As illustrated in left below positioning 8 holes on the wall and drill the holes at the corresponding position.
- Screw the "monitor wall mount bracket" with 8 expansion bolts to fix it on the wall. (4 on top line, 4 on the bottom line.)

Step. 3

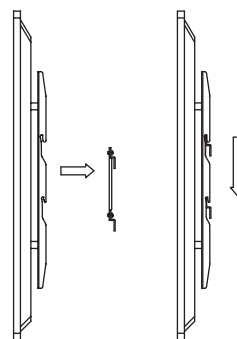

According to the step ①, ②, lock the wall "wall mount crossbar bracket" with the monitor onto the wall mount holder which has been fixed on the wall.

Step. 2

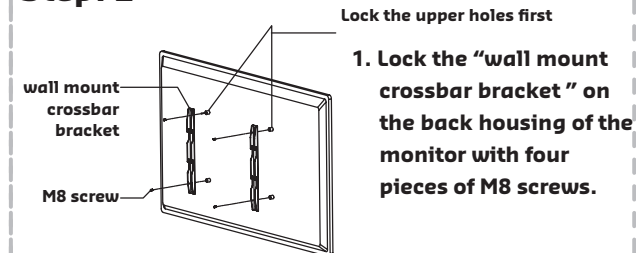

Lock the upper holes first

1. Lock the "wall mount crossbar bracket" on the back housing of the monitor with four pieces of M8 screws.

※ Caution: the direction of the connectors should be strictly confirm to the diagram illustrated above.)

- Attention! When locking the "wall mount crossbar bracket" on the monitor, please make sure the holes are in the same horizontal position.

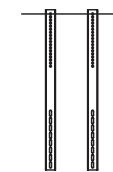

① Lock the holes in the same horizontal position.

Step. 4

Can be adjusted from left and right

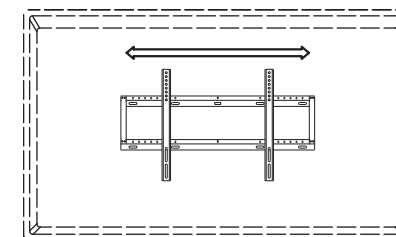

Check whether the wall mount connector is soundly locked onto the "monitor wall mount bracket". The monitor can be adjusted from left to right and vice versa.